

# WL20

## Wireless Time Attendance Terminal



WL20 is Fingerprint Time & Attendance Terminal with Wi-Fi module. With Wi-Fi function, User needn't wire Ethernet cable, it supports hotspot mode and allow mobile APPs connection and check in/out and download record directly. It's associated with ZK new fingerprint reader, the operation remains stable under strong light source and high preciseness of verification of wet and rough fingers. It also has elegant design, it will start new stage of time attendance.

---

### Features

- Wi-Fi, USB client & host
- Stable operation under strong light source
- Infrared auto-turning on function to save power
- Quick recognition of dry, wet and rough fingers
- Time Cube Cloud Solution
- Mobile phone APP TA Assistant download report and shift Management
- Build-in SSR Excel software, Shift and Report management

# Specifications

Fingerprint Capacity	1000 / 1500 (without SSR)
Finger Algorithm	ZKFinger VX10.0
Record Capacity	50,000
Display	2.8-inch TFT Screen
Communication	Wi-Fi , USB-Host, USB-Client
Standard Functions	SSR, DST, Scheduled-bell, Self-Service Query, Automatic Status Switch, T9 Input 9 digit user ID
Optional Functions	TA Assistant APP Time Cube Cloud Solution
Power Supply	DC 5V 0.8A
Operating Temp	0 °C- 45 °C
Operating Humidity	20%-80%
Dimension	165 x 133 x 21 mm

## Configuration

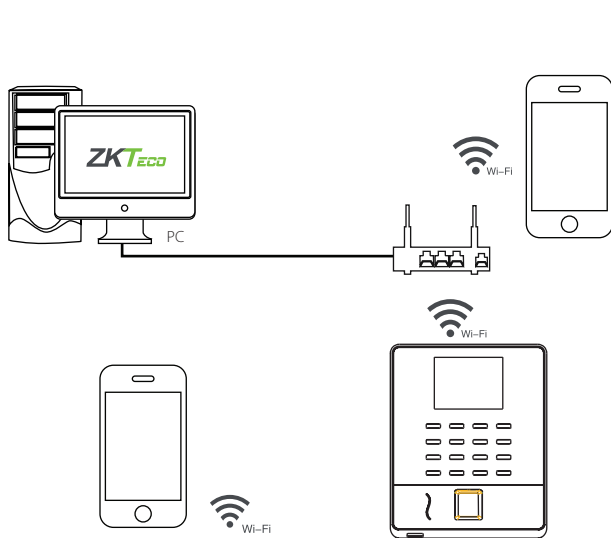

## Dimensions

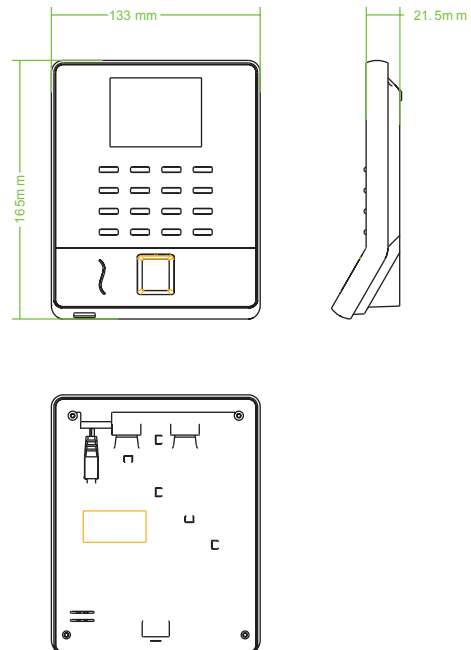

ZKTECO CO., LTD.  
E-mail: [sales@zkteco.com](mailto:sales@zkteco.com)  
[www.zkteco.com](http://www.zkteco.com)

© Copyright 2015. ZKTeco Inc. ZKTeco Logo is a registered trademark of ZKTeco or a related company. All other product and company names mentioned are used for identification purposes only and may be the trademarks of their respective owners. All specifications are subject to change without notice. All rights reserved.