

ProRF-T

RFID Access Control Terminal



ProRF-T is an RFID access control terminal incorporated with 2.4 inches TFT LCD Screen. The color display and new firmware structure offer a user-friendly menu for easy management, as well as photo taking capability that enables attendance photos and photo ID (optional). The new ZMM 220 hardware platform has a clock rate of 1.2 GHZ, greatly enhancing the speed verification. Touch keypad enables easy and convenient operations, such as managing users, accessing control parameter settings, or reading reports.

Features



Modern Design & Interactive UI



Simple Management & Scalability

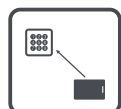

Multiple Verification Modes:
Card / Password



Built In Camera
* Event Snapshot
* User Photo (Optional)



Touch Keypad

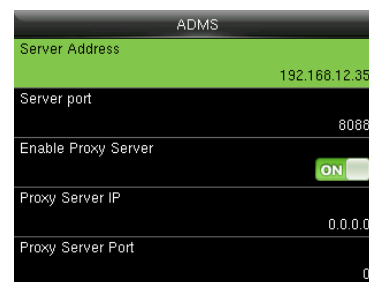
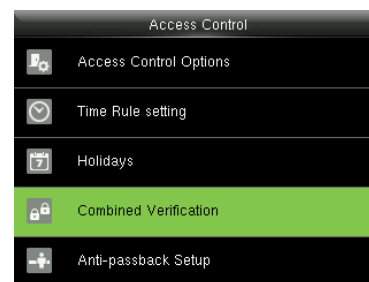
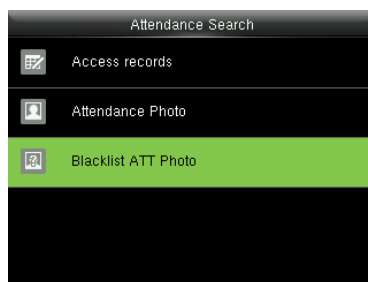

Specifications Ⓞ: GL Exclusive Feature)

Capacity

Cards	50,000
Transactions	100,000
User Photos	3,000
Event Photos	7,000

Communication

- Ⓞ TCP / IP
- USB Host
- Wiegand Input / Output
- Security Relay Box

Access Control Interface

- Lock Relay Output
- Alarm Output / Auxiliary Input
- Exit Button / Door Sensor
- Doorbell Output

Hardware

- Ⓞ 1.2GHz High Speed CPU
- Ⓞ Memory 128MB RAM / 256MB Flash
- 2.4 Inches TFT-LCD Screen
- 125KHz EM Reader / Mifare (Optional)
- Hi-Fi Voice & Indicator
- Tamper Switch Alarm
- Ⓞ Touch Keypad
- Ⓞ 120° Wide Angle Camera

Standard Functions

- Access Levels / Groups / Holidays
- DST / Bell Schedule
- Duress Mode (Password)
- Anti-Passback
- Record Query
- Custom Wallpaper & Screen Saver

Special Functions

- Ⓞ Multiple Verification Modes
- Ⓞ Event Snapshot
- User Photo (Optional)
- ZK Encrypted Card (Optional)

Compatibility

- Wiegand Slave Reader
- ZKBioSecurity Software

Additional Info

- Working Temperature: -10 °C ~ 50 °C
- Dimensions: 195.5 × 87 × 35 mm.
- Package Includes 12V 3A Power Supply

Power

- Operating Voltage 12V DC
- Current Draw < 500mA

Configuration

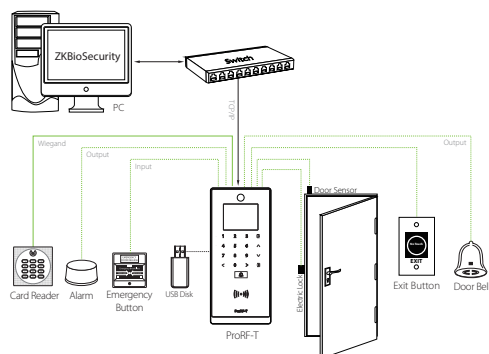

Dimensions (mm)

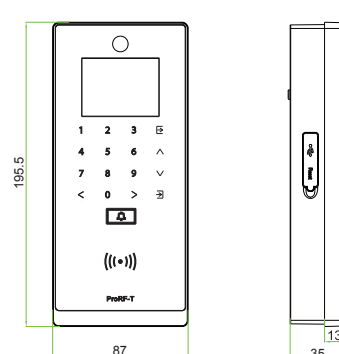

ZKTeco Inc.
www.zkteco.com
E-mail: sales@zkteco.com



© Copyright 2016, ZKTeco Inc. ZKTeco Logo is a registered trademark of ZKTeco or a related company. All other product and company names mentioned are used for identification purposes only and may be the trademarks of their respective owners. All specifications are subject to change without notice. All rights reserved.