

# G3

## Multi-Biometric Time Attendance & Access Control Terminal



**G3** is a multi-biometric identification terminal which features ZKTeco's innovation Silk ID fingerprint sensor technology. With the world's cutting-edge 3D Neuron Fingerprint Algorithm, it precisely authenticates dry, wet, or rough fingerprints efficiently and accurately. Infrared technology enables the device to function automatically when fingerprints are detected. With the latest facial algorithm, it supports fake face detection.

## Features



Modern Design & Interactive UI



Revolutionary SilkID Fingerprint Sensor



Multiple Verification Modes:  
Face / Fingerprint / Card / Password



Outstanding Performance With  
Dry, Wet and Rough Fingers



Simple Management & Scalability

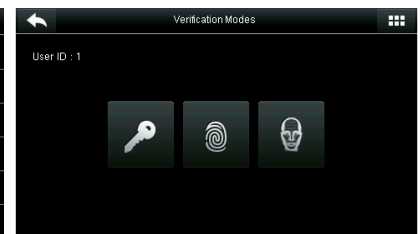
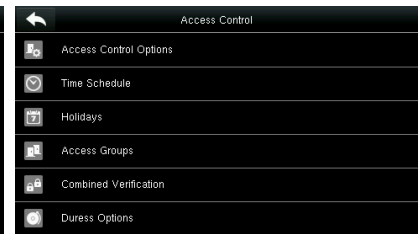
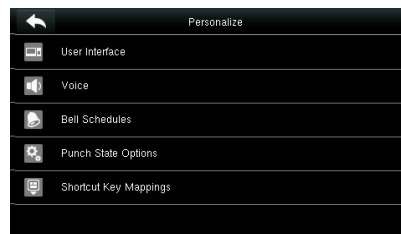

## Specifications G: GL Exclusive Feature)

### Capacity

Fingerprints	5,000
Faces	3,000 (1:N) / 4,000 (1:1)
Cards (Optional)	10,000
Transactions	100,000

### Communication

TCP/IP  
USB Host  
Wiegand Output

### Access Control Interface

Lock Relay Output  
Alarm Output  
Exit Button  
Door Sensor  
External Bell

### Hardware

- G 1.2GHz High Speed CPU
- G Memory 128MB RAM / 256MB Flash
- SilkID Fingerprint Sensor
- G 4.3 Inches Touch Screen
- Hi-Fi Voice & Indicator
- Tamper Switch Alarm

### Standard Functions

ID Card / Work Code / WDMS  
DST / SMS / Bell Schedule  
Attendance Status Auto-Switch  
Record Query / Photo ID  
Custom Wallpaper & Screen Saver

### Special Functions

- G Multiple Biometric Verification Modes
- G Alive Finger Detection
- G Duplicate Face Detection

### Optional Functions:

- HID Proxy / Mifare Card Reader
- G Wi-Fi / 3G
- External Printer
- G Battery (2,000 mAh)
- G POE(Standard IEEE 802.3at)

### Compatibility

ZKTime.Web  
ZKAccess 3.5  
WDMS

### Additional Info

Working Temperature: 0 °C ~ 45 °C  
Dimensions: 199.2 × 171.8 × 96.9 mm  
ZKFace v7.0 & ZKFinger v10.0 Algorithms  
Fingerprint: FAR≤0.0001% FRR≤0.01%  
Face: FAR≤0.001% FRR≤1%

### Power

Operating Voltage 12V DC  
Current Draw < 500 mA

## Configuration

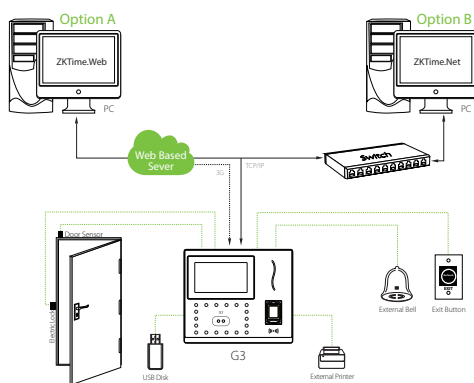

## Dimensions (mm)

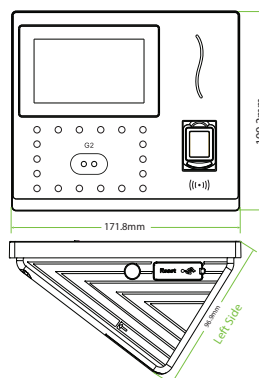

ZKTECO CO.,LTD.  
www.zkteco.com  
E-mail: sales@zkteco.com



© Copyright 2017 ZKTECO CO.,LTD. ZKTECO Logo is a registered trademark of ZKTECO or a related company. All other product and company names mentioned are used for identification purposes only and may be the trademarks of their respective owners. All specifications are subject to change without notice. All rights reserved.